

## INSTRUCTION MANUAL

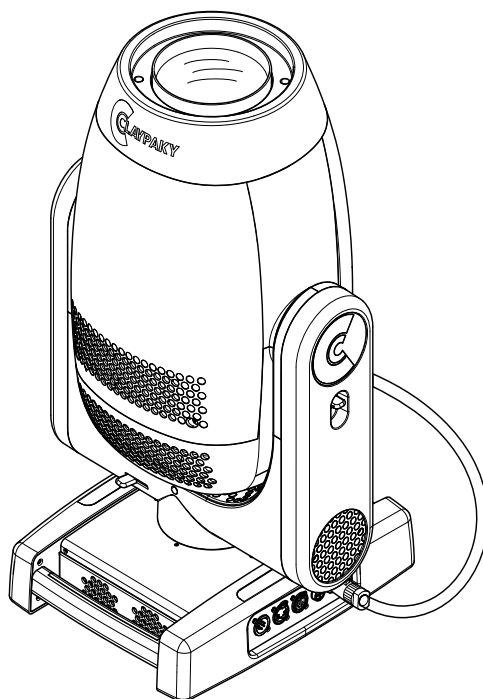

### INDEX

Page	Contents
2	<b>1. Safety information</b>
3	<b>2. Unpacking and preparation</b>
4	<b>3. Installation and start-up</b>
4	3.1 Installing the fixture
4	3.2 Connecting to mains supply
5	3.3 Connecting the control signal line: DMX / Art-Net
5	3.4 Switching on the fixture and basic SetUp
7	<b>4. Maintenance</b>
7	4.1 Opening the covers
8	4.2 Periodical cleaning
9	4.3 Effects module removal
11	4.4 Cleaning of the filters
13	4.5 Rotating gobos
14	4.6 Battery removal
15	<b>5. Specifications</b>

*Congratulations on choosing a Claypaky product!*

*We thank you for your custom.*

*Please note that this product, as all the others in the rich Claypaky range, has been designed and made with total quality to ensure excellent performance and best meet your expectations and requirements.*

# 1. SAFETY INFORMATION

**EN**

## **SAFETY INFORMATION**

IMPORTANT: Claypaky recommends you carefully read and keep the safety information on this product, also available in digital format at the following link:

**[www.claypaky.com](http://www.claypaky.com)**

Ref: FIS00T - Safety Information Axcor 400 series

**IT**

## **INFORMAZIONI DI SICUREZZA**

IMPORTANTE: Claypaky raccomanda di leggere accuratamente e conservare le informazioni di sicurezza relative a questo prodotto, sempre reperibili in versione digitale al seguente link:

**[www.claypaky.com](http://www.claypaky.com)**

Rif: FIS00T - Safety Information Axcor 400 series

**DE**

## **INFORMATIONEN ZUR SICHERHEIT**

WICHTIG: Claypaky empfiehlt, die Sicherheitsinformationen bezüglich dieses Produkts genau zu lesen und aufzubewahren. Sie sind in Digitalversion immer unter folgendem Link auffindbar:

**[www.claypaky.com](http://www.claypaky.com)**

Ref: FIS00T - Safety Information Axcor 400 series

**ES**

## **INFORMACIONES DE SEGURIDAD**

IMPORTANTE: Claypaky recomienda leer detenidamente y conservar la información de seguridad relativa a este producto. Además, está disponible una versión digital de la misma en el siguiente enlace:

**[www.claypaky.com](http://www.claypaky.com)**

Ref: FIS00T - Safety Information Axcor 400 series

**FR**

## **CONSIGNES DE SÉCURITÉ**

IMPORTANT: Claypaky recommande de lire attentivement et de conserver les informations de sécurité relatives à ce produit, disponibles en version digitale au lien suivant:

**[www.claypaky.com](http://www.claypaky.com)**

Réf. : FIS00T - Safety Information Axcor 400 series

**RU**

## **ИНСТРУКЦИЮ ПО ТЕХНИКЕ БЕЗОПАСНОСТИ**

ВАЖНО: Claypaky рекомендует внимательно прочитать и сохранить инструкцию по технике безопасности данного изделия, которая всегда доступна в электронном формате по следующей ссылке:

**[www.claypaky.com](http://www.claypaky.com)**

Наименование: FIS00T - Safety Information Axcor 400 series

## 2. UNPACKING AND PREPARATION

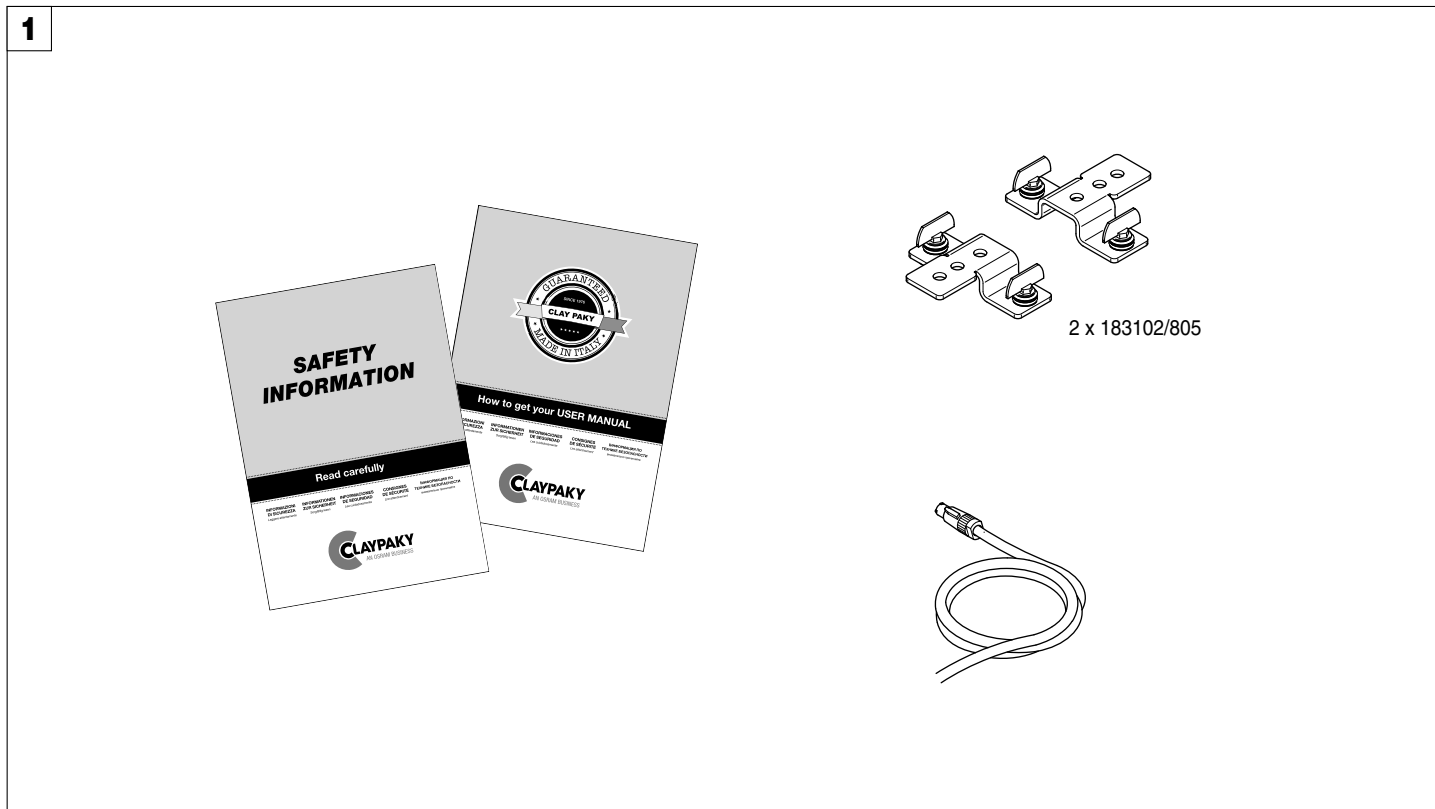

Packing contents - Fig. 1

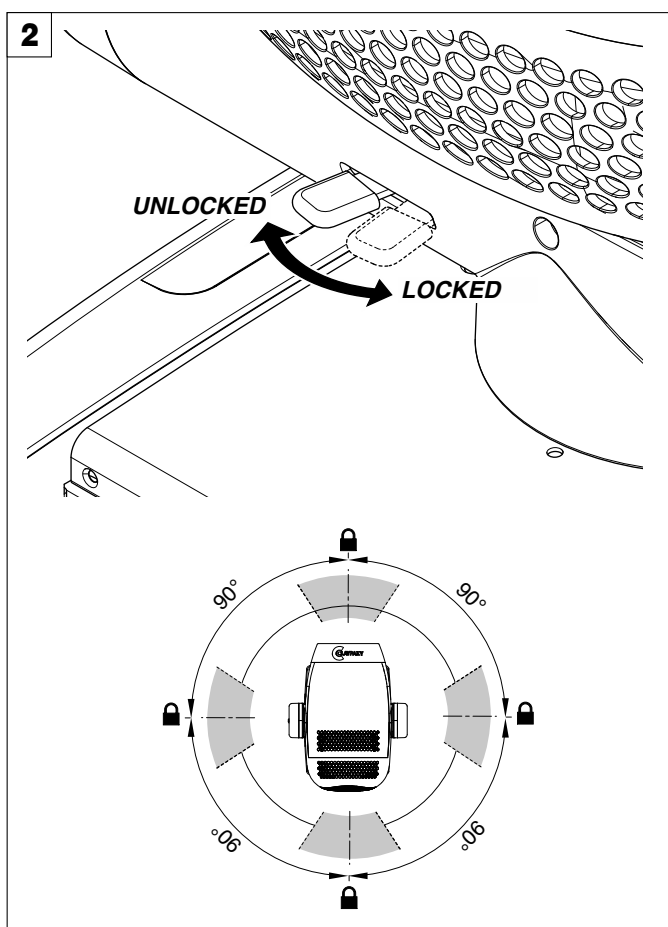

PAN Mechanism Lock and Release (every 90°) - Fig. 2

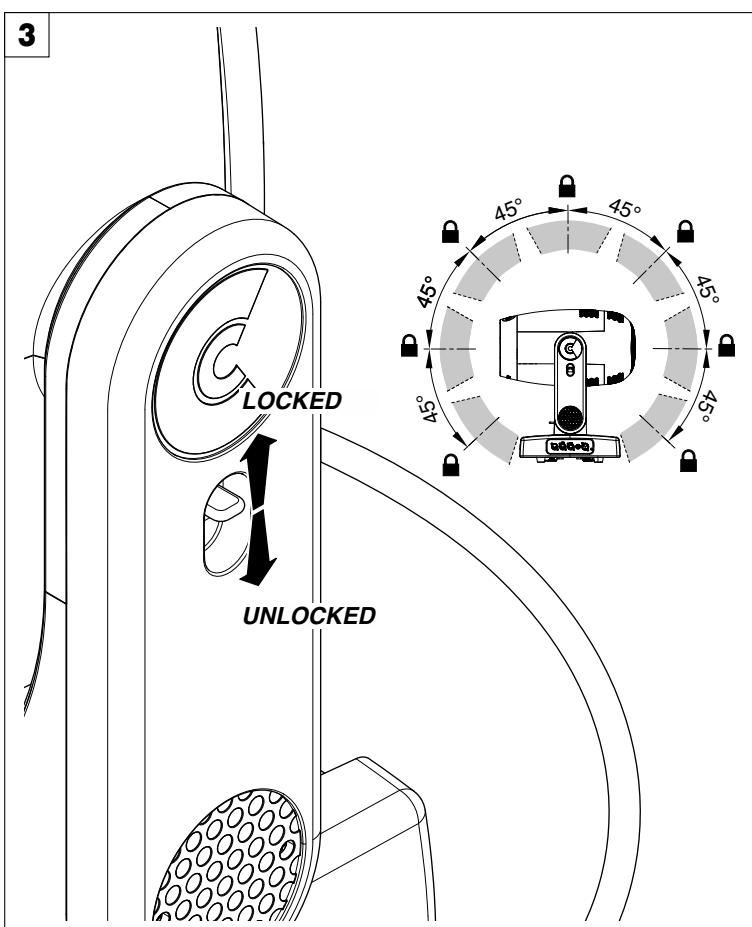

TILT Mechanism Lock and Release (every 45°) - Fig. 3

### 3. INSTALLATION AND START-UP

#### 3.1 Installing the fixture

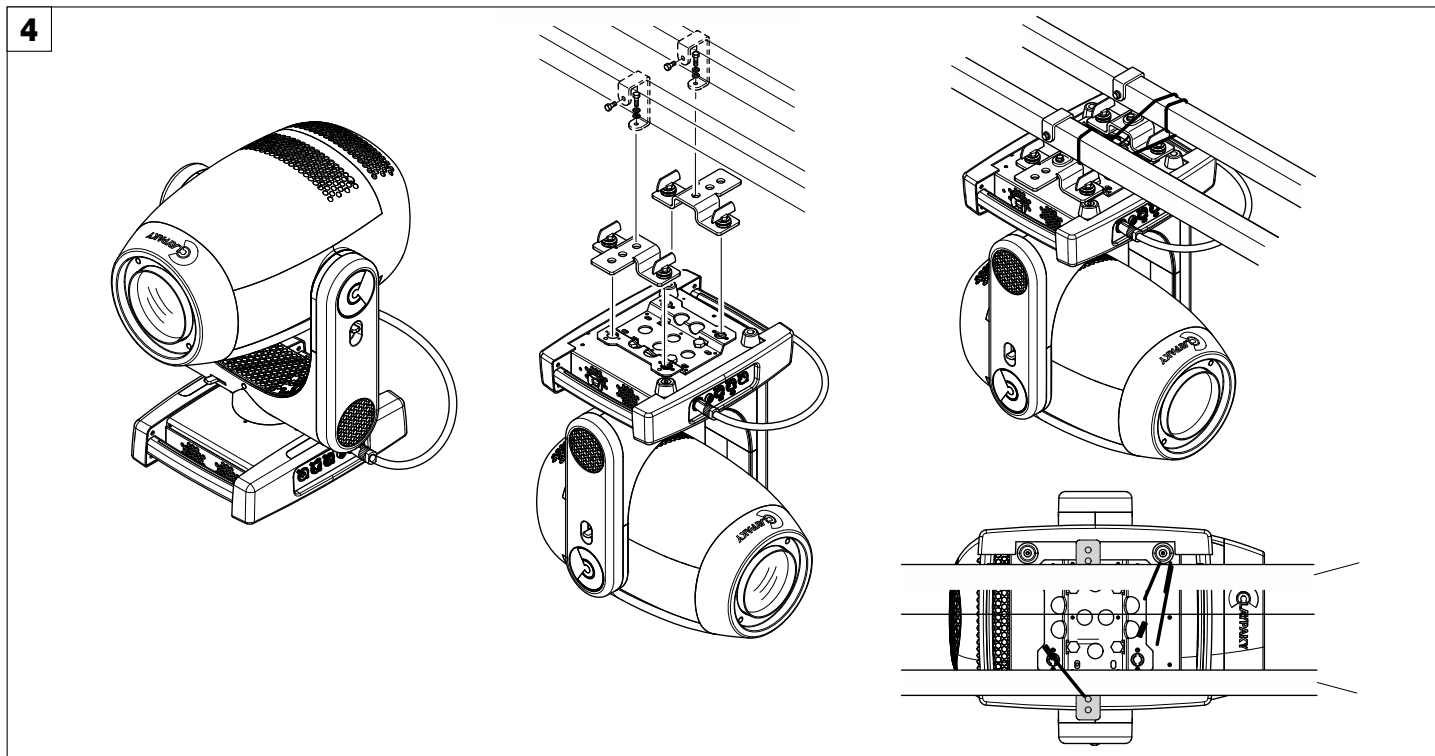

Installing the projector - Fig. 4

The projector can be installed on the floor resting on special rubber feet, on a truss or on the ceiling or wall.

**WARNING:** with the exception of when the projector is positioned on the floor, the safety cable must be fitted. (Cod. 105041/001 available on request). This must be securely fixed to the support structure of the projector and then connected to the fixing point at the centre of the base.

#### 3.2 Connecting to mains supply

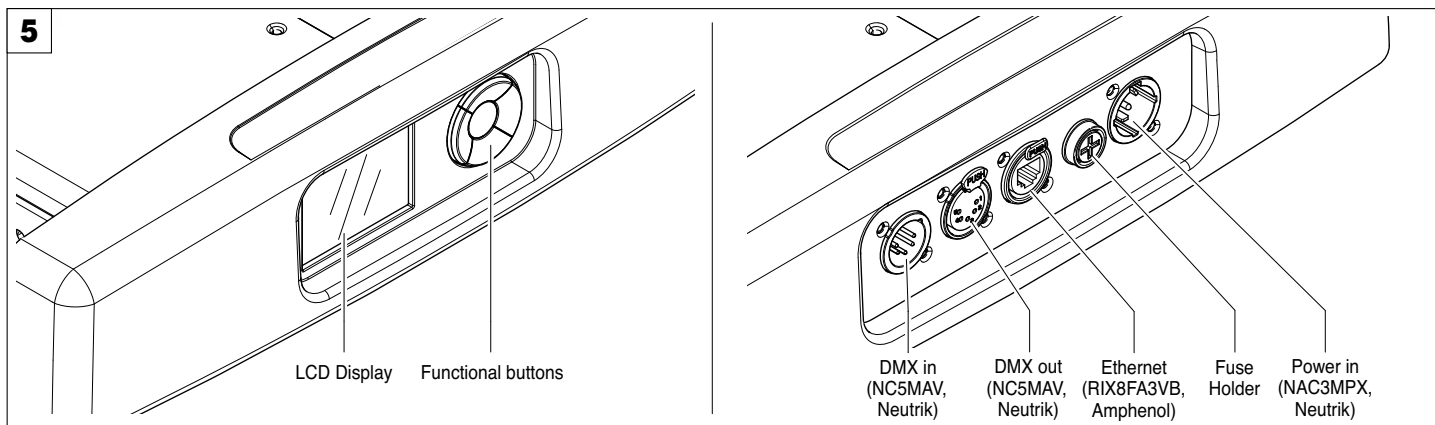

Control Panel - Fig. 5

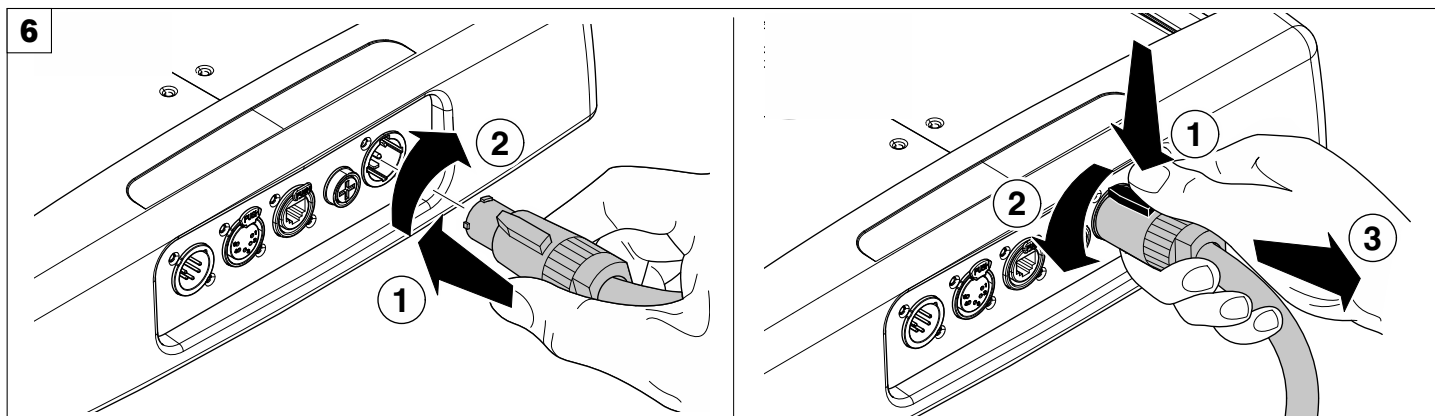

Connecting and disconnecting power cable - Fig. 6

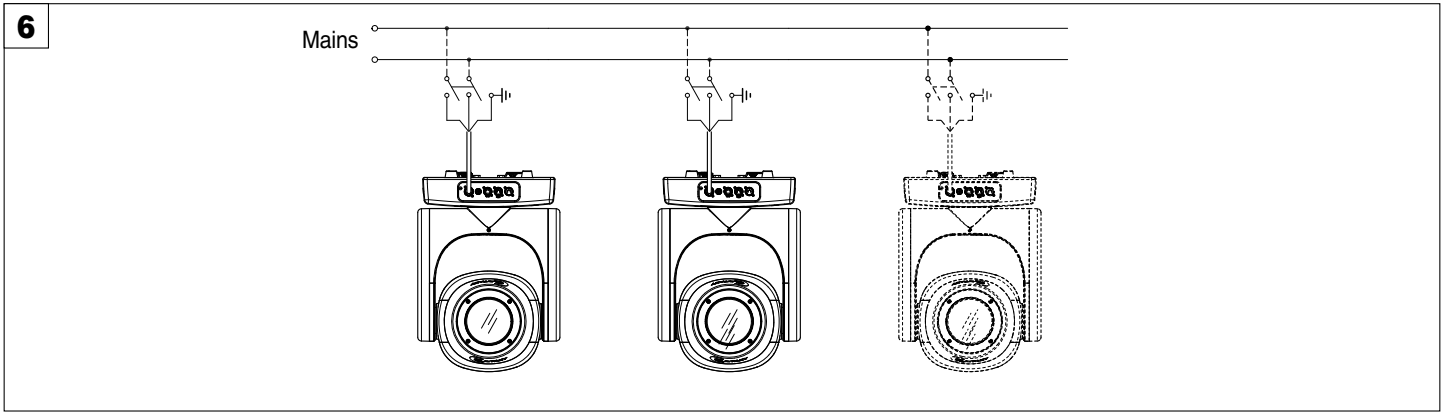

Connecting to the mains supply - Fig. 6

### 3.3 Connecting the control signal line: DMX / Art-Net

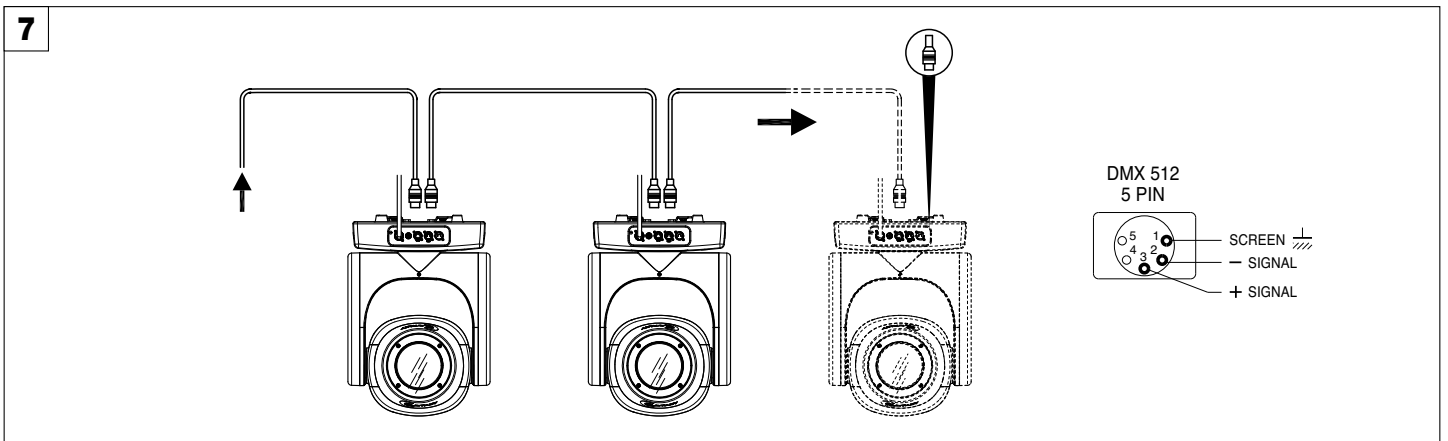

Connecting to the control signal line (DMX) - Fig. 7

Use a cable conforming to specifications EIA RS-485: 2-pole twisted, shielded, 120Ohm characteristic impedance, 22-24 AWG, low capacity. Do not use microphone cable or other cable with characteristics differing from those specified. The end connections must be made using XLR type 5 pin male/female connectors. A terminating plug must be inserted into the last projector with a resistance of 120Ohm (minimum 1/4 W) between terminals 2 and 3.

**IMPORTANT:** The wires must not make contact with each other or with the metal casing of the connectors. The casing itself must be connected to the shield braid and to pin 1 of the connectors.

### 3.4 Switching on the fixture and basic SetUp

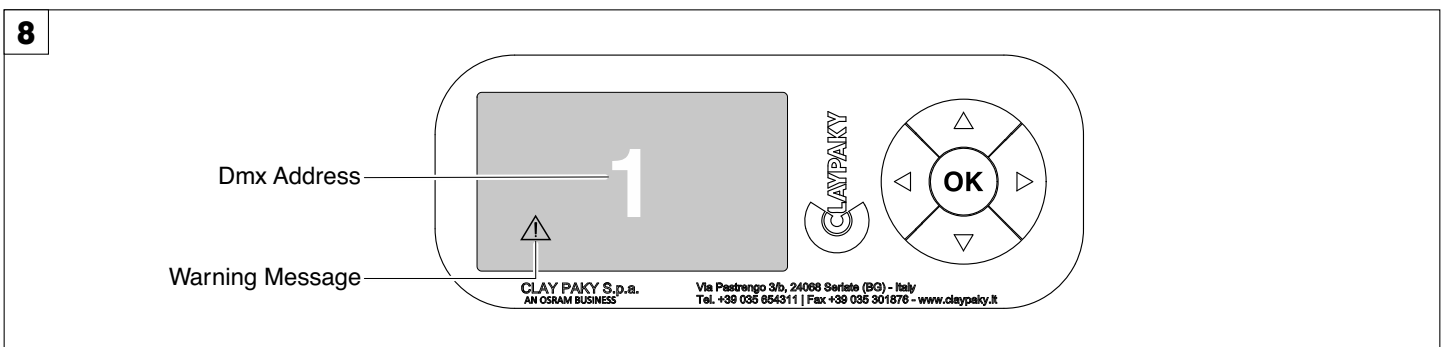

Switching on the projector - Fig. 8

Press the switch. The projector starts resetting the effects. At the same time, the following information scrolls on the display:



	<b>Model</b> Axcor 400	<b>Firmware</b> Version X.X.X Date - Hour	<b>Dmx Address xxx</b>	<b>System errors</b> ..... .....
---	------------------------------	---	------------------------	--

On conclusion of resetting in case of absence of the dmx signal, Pan and Tilt move to the "Home" position (Pan 128 bit - Tilt 128 bit). The control panel (Fig. 8) has a display and buttons for the complete programming and management of the projector menu. The display can be in one of two conditions: rest status and setting status. When it is in the rest status, the display shows the projector's DMX address.

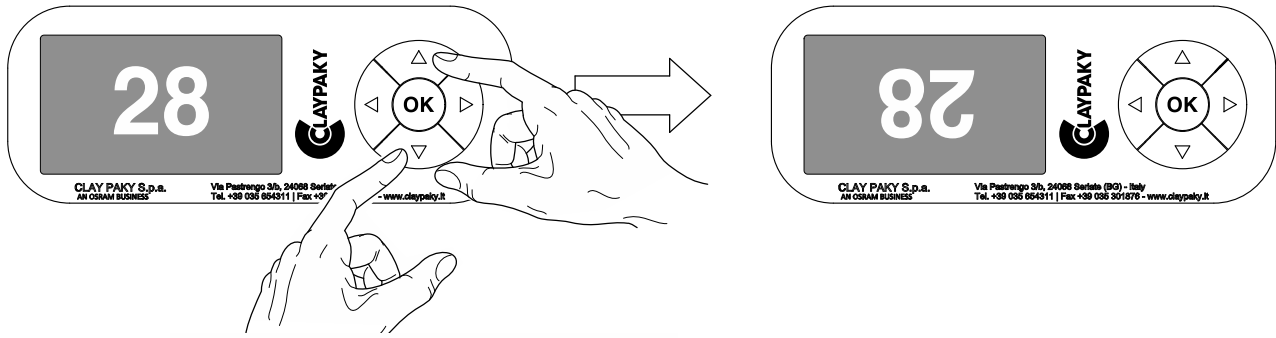
During menu setting status, after a wait time (about 30 seconds) without any key having been pressed, the display automatically returns to rest status. It should be noted that when this condition occurs, any possible value that has been modified but not yet confirmed with the **OK** key will be cancelled.



### Reversal of the display - Fig. 9

To activate this function, press UP  and DOWN  keys simultaneously while the display is in the rest mode. This status will be memorised and maintained even for the next time it will be switched on. To return to the initial state, repeat the operation all over again.

### Setting the projector starting address

On each projector, the starting address must be set for the control signal (addresses from 1 to 512).

The address can also be set with the projector switched off.

## Functions of the buttons - Using the menu

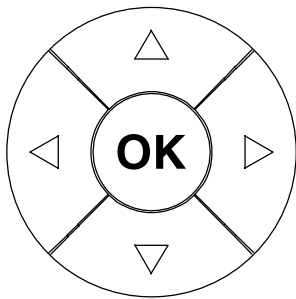

Confirms the displayed value, or activates the displayed function, or enters the successive menu.



DOWN

Decreases the value displayed (with auto-repetitions) or passes to the next item in the menu.



UP

Increases the value displayed (with auto-repetitions) or passes to the previous item in a menu.



LEFT







Return to the top level

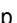

RIGHT

Commute from units, tens, hundreds, in the "Address" and "Calibration" menu.

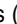
### USING THE MENU:

- 1) Press LEFT  once – "Main Menu" appears on the display.
- 2) Use the UP  and DOWN  keys to select the menu to be used:
  - Setup (Setup Menu): To set the setting options.
  - Option (Option Menu): To set the operating options
  - Informations (Informations Menu): To read the counters, software version and other information.
  - Manual Control (Manual control Menu): To trigger the test and manual control functions.
  - Test (Test Menu): To check the proper functioning of effects
  - Advanced (Advanced Menu): Access to the "Advanced menu" is recommended for a trained technical personnel.
- 3) Press  to display the first item in the selected menu.
- 4) Use the UP  and DOWN  keys to select the MENU items.

### Setting addresses and options with the projector disconnected

The projector's DMX address, as well as other possible operating options, can also be set when the appliance is disconnected from the electricity supply. All that is needed is to press RIGHT  to momentarily activate the display and thus access the settings. Once the required operations have been carried out, the display will switch off again after a wait time of 30 seconds.

## 4. MAINTENANCE

### 4.1 Opening the covers

10

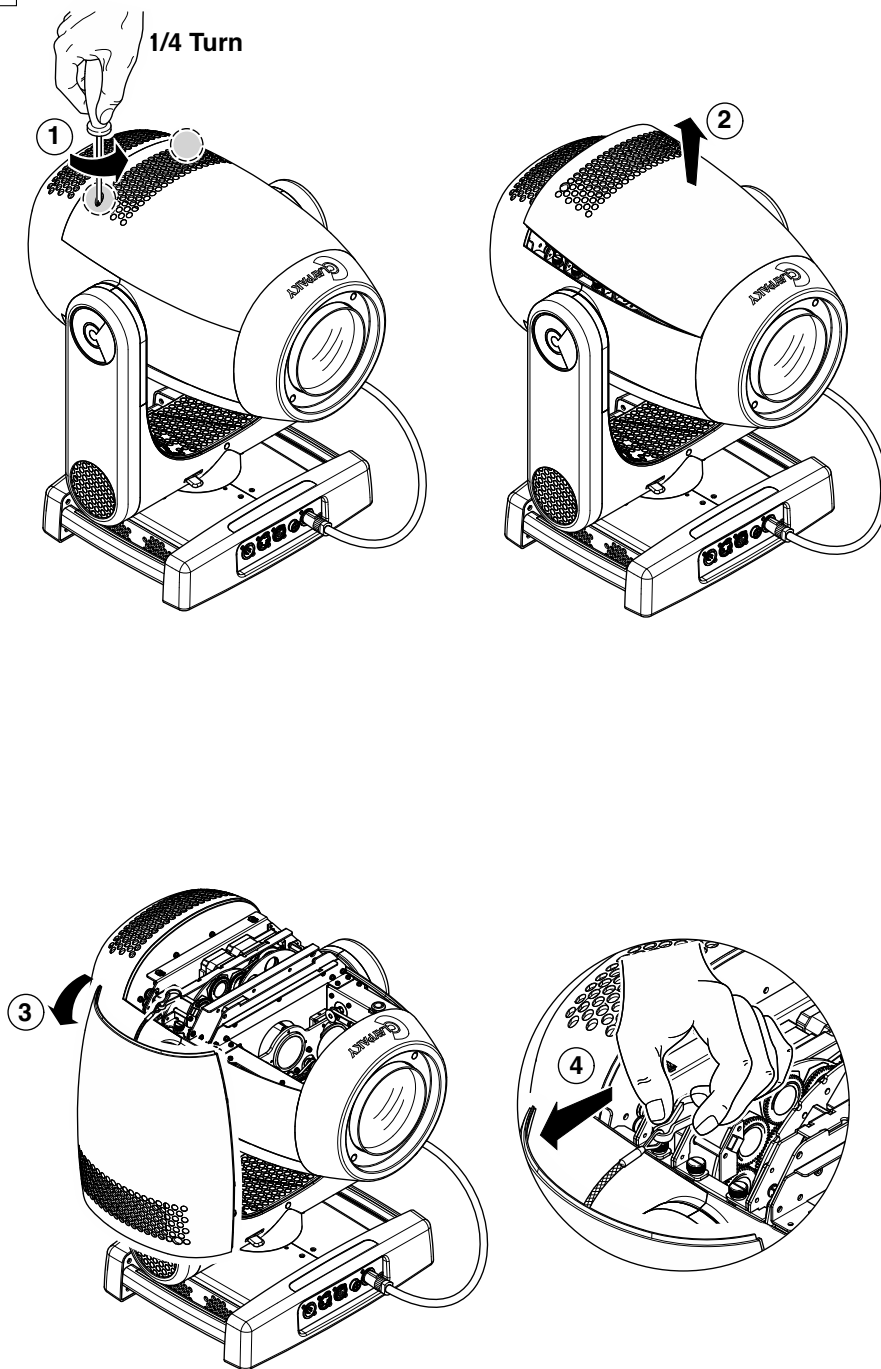

11

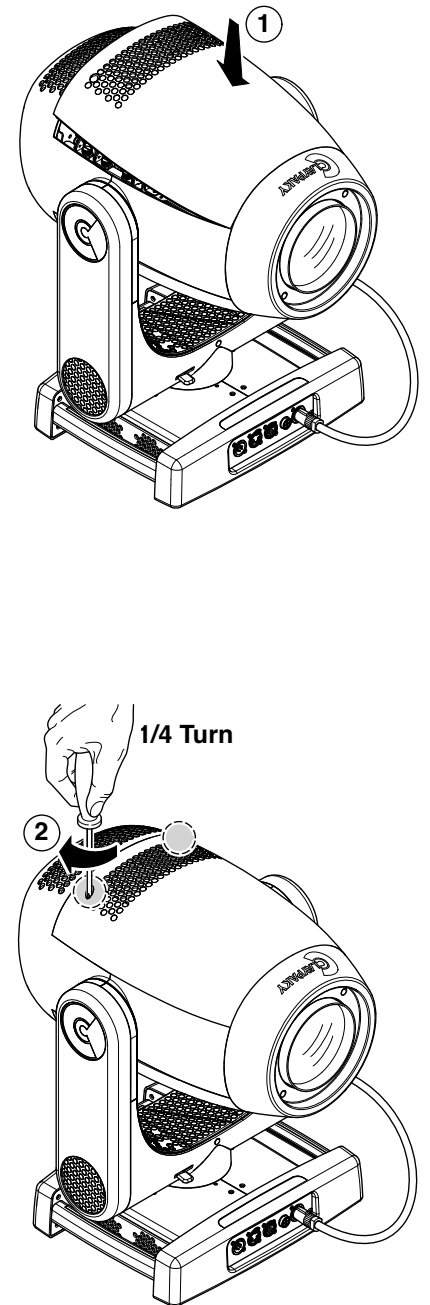

**Locking and releasing Pan and Tilt movements** - Refer to the instructions in the UNPACKING AND PREPARATION section.

**Opening the head covers** - Fig. 10.

**Closing the head covers** - Fig. 11.

## 4.2 Periodical cleaning

12

**NOTE:** keep a careful cleaning of the "CMY/colour filters assembly" to prevent rapid deterioration.



### Light collimation system

This product contains internal light collimation system. Avoid intense light from any angle.

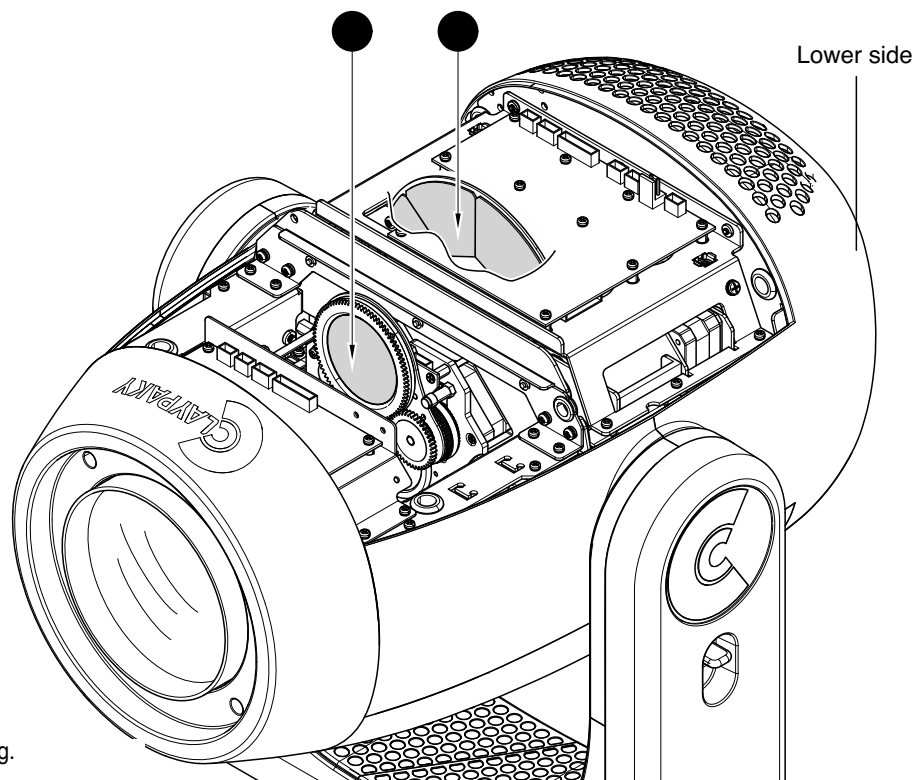
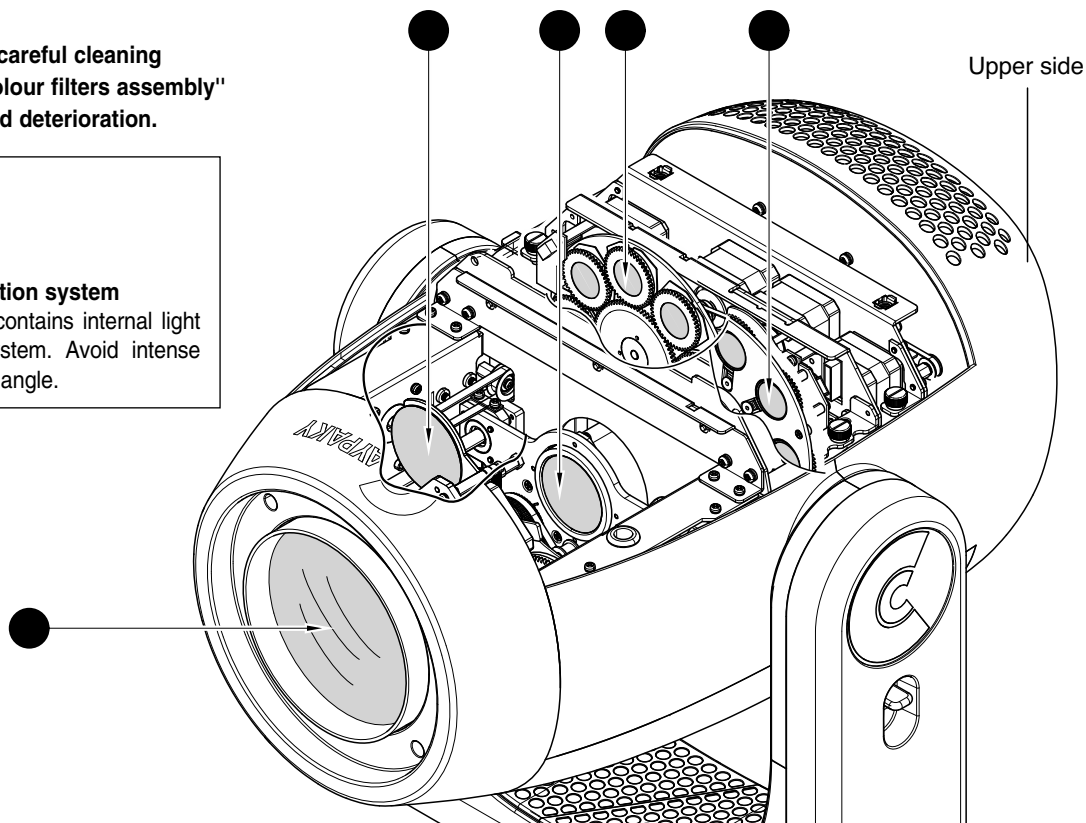

● Parts requiring frequent cleaning.

### Periodical cleaning - Fig. 12

To ensure optimal operation and performance for a long time it is essential to periodically clean the parts subject to dust and grease deposits. The frequency with which the following operations are to be carried out depends on various factors, such as the amount of the effects and the quality of the working environment (air humidity, presence of dust, salinity, etc.).

Use a soft cloth dampened with any detergent liquid for cleaning glass to remove the dirt from the reflectors, from the lenses and filters. It is recommended that the projector undergoes an annual service by a qualified technician for special maintenance involving at least the following operations:

- General cleaning of internal parts.
- Restoring lubrication of all parts subject to friction, using lubricants specifically supplied by Claypaky.
- General visual check of the internal components, cabling, mechanical parts, etc.
- Electrical, photometric and functional checks; eventual repairs.



### 4.3 Effects module removal

13

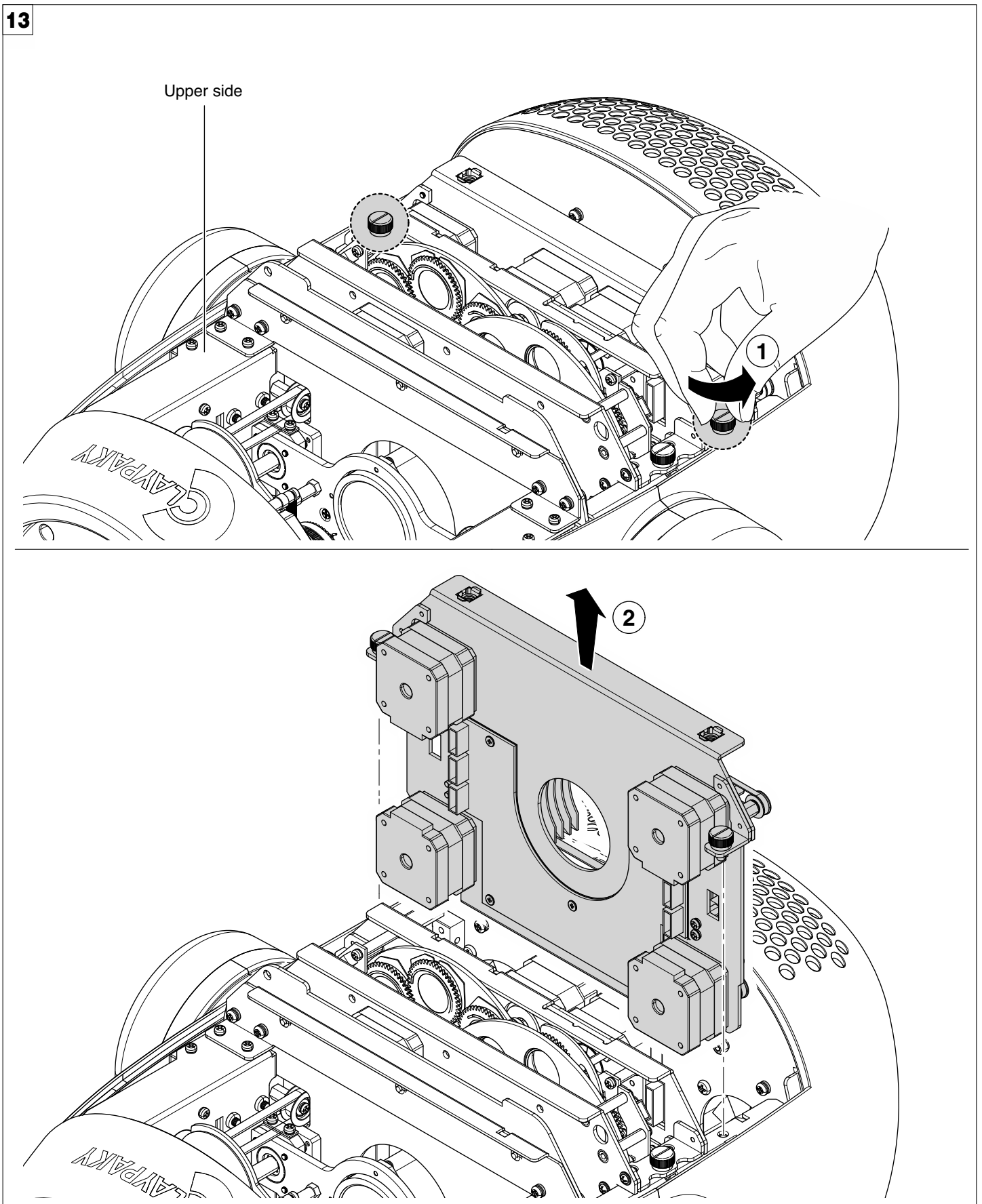

Extraction of the effect modules - Fig. 13.

**IMPORTANT:** Grasp the modules using the support structure and not the details which could get damaged.

**Insertion of the effect modules:** Repeat the operations indicated in Fig. 13 and 14 in reverse order.

**NOTE:**

- Do not disconnect wiring harnesses when the fixtures is switched-on, to avoid to damage electronic boards.
- Do not switch-on the fixtures with wiring harness disconnected.

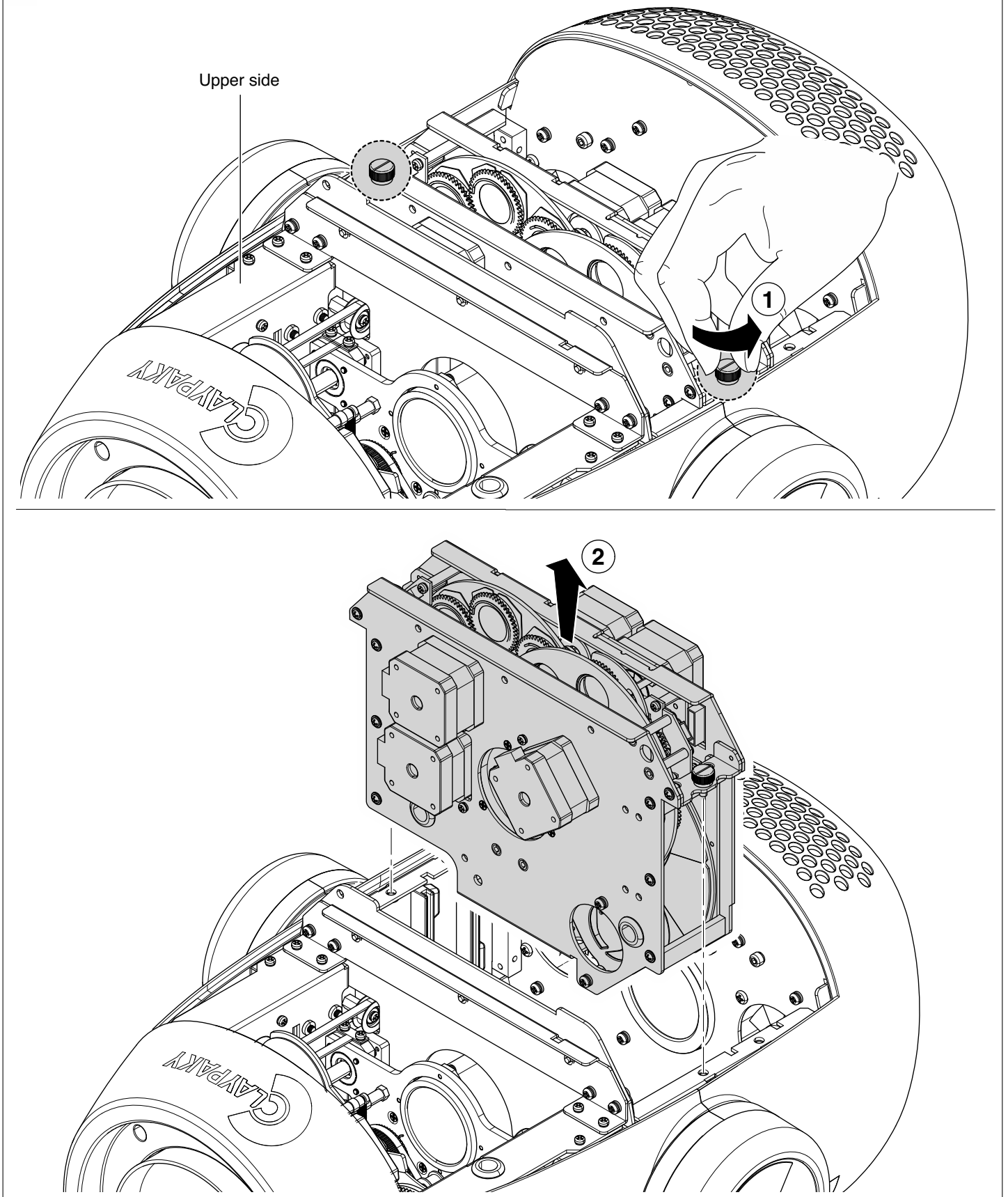

Extraction of the effect modules - Fig. 14.

**IMPORTANT:** Grasp the modules using the support structure and not the details which could get damaged.

**Insertion of the effect modules:** Repeat the operations indicated in Fig. 13 and 14 in reverse order.

**NOTE:**

- Do not disconnect wiring harnesses when the fixtures is switched-on, to avoid to damage electronic boards.
- Do not switch-on the fixtures with wiring harness disconnected.

#### 4.4 - Cleaning of the filters

15



Cleaning of the filters - Fig. 15.

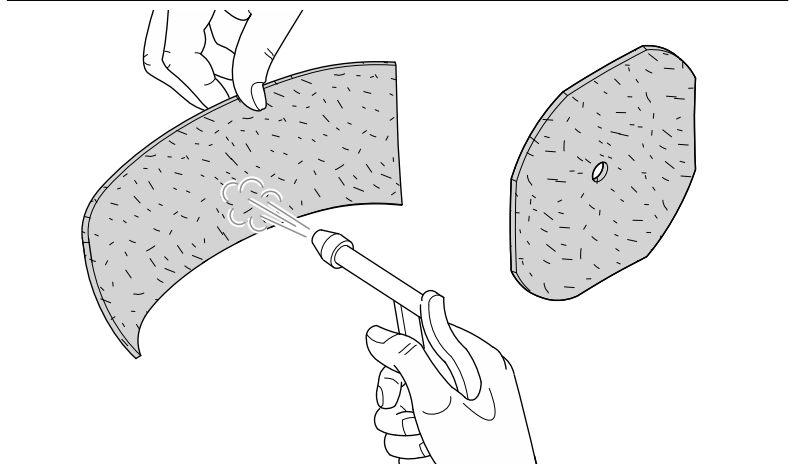
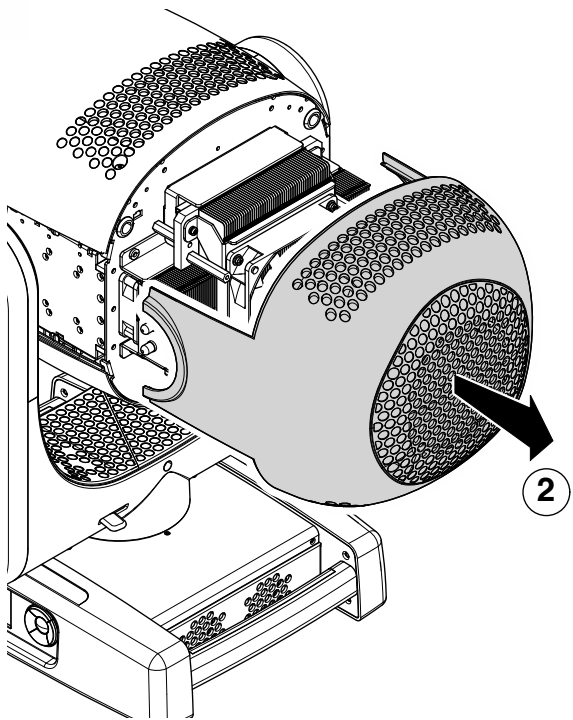
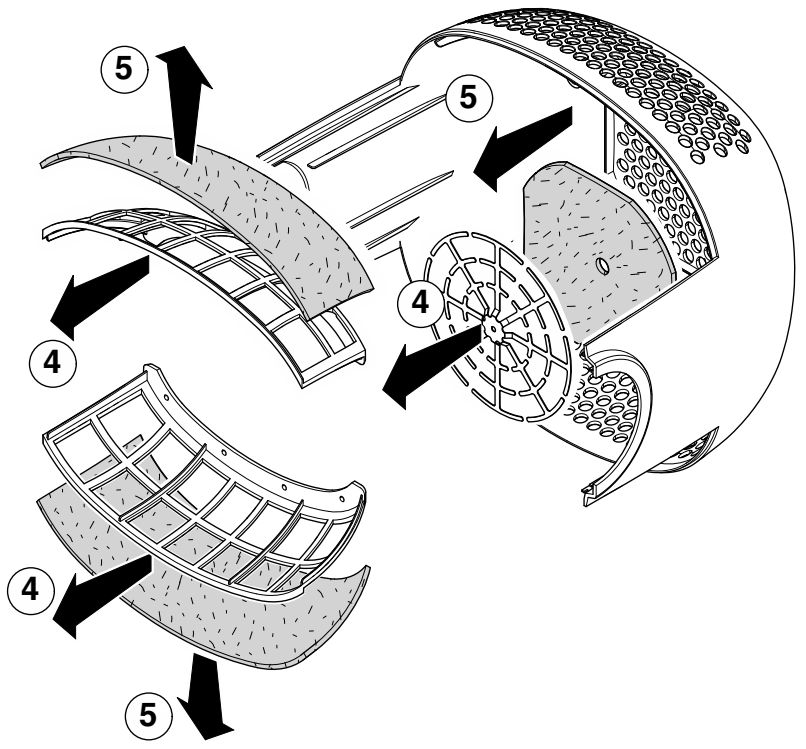
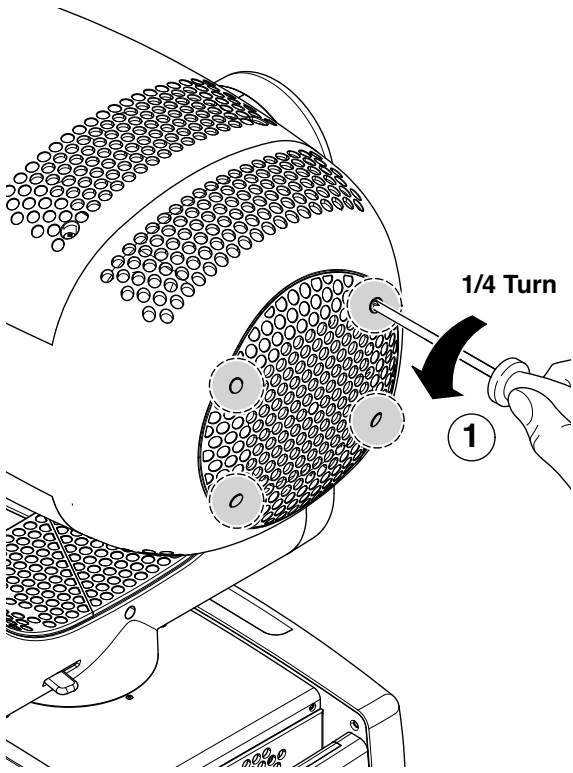
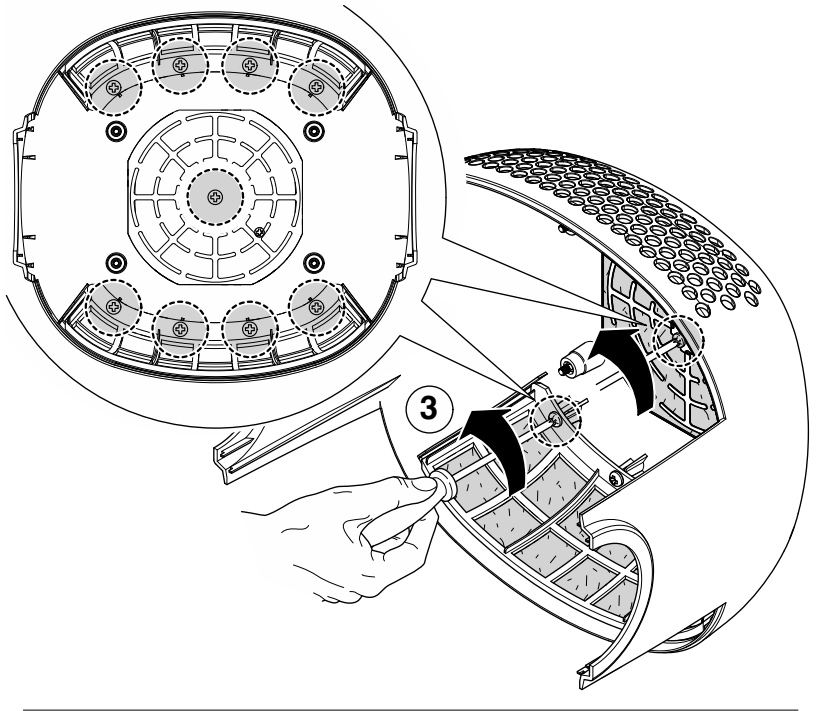
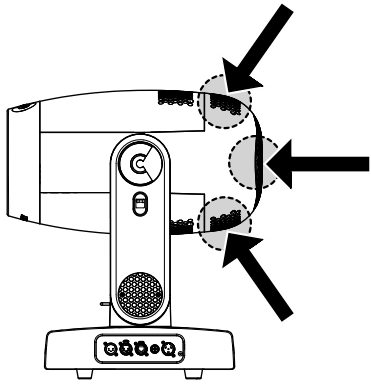

Cleaning of the filters - Fig. 16.

## 4.5 - Rotating gobos

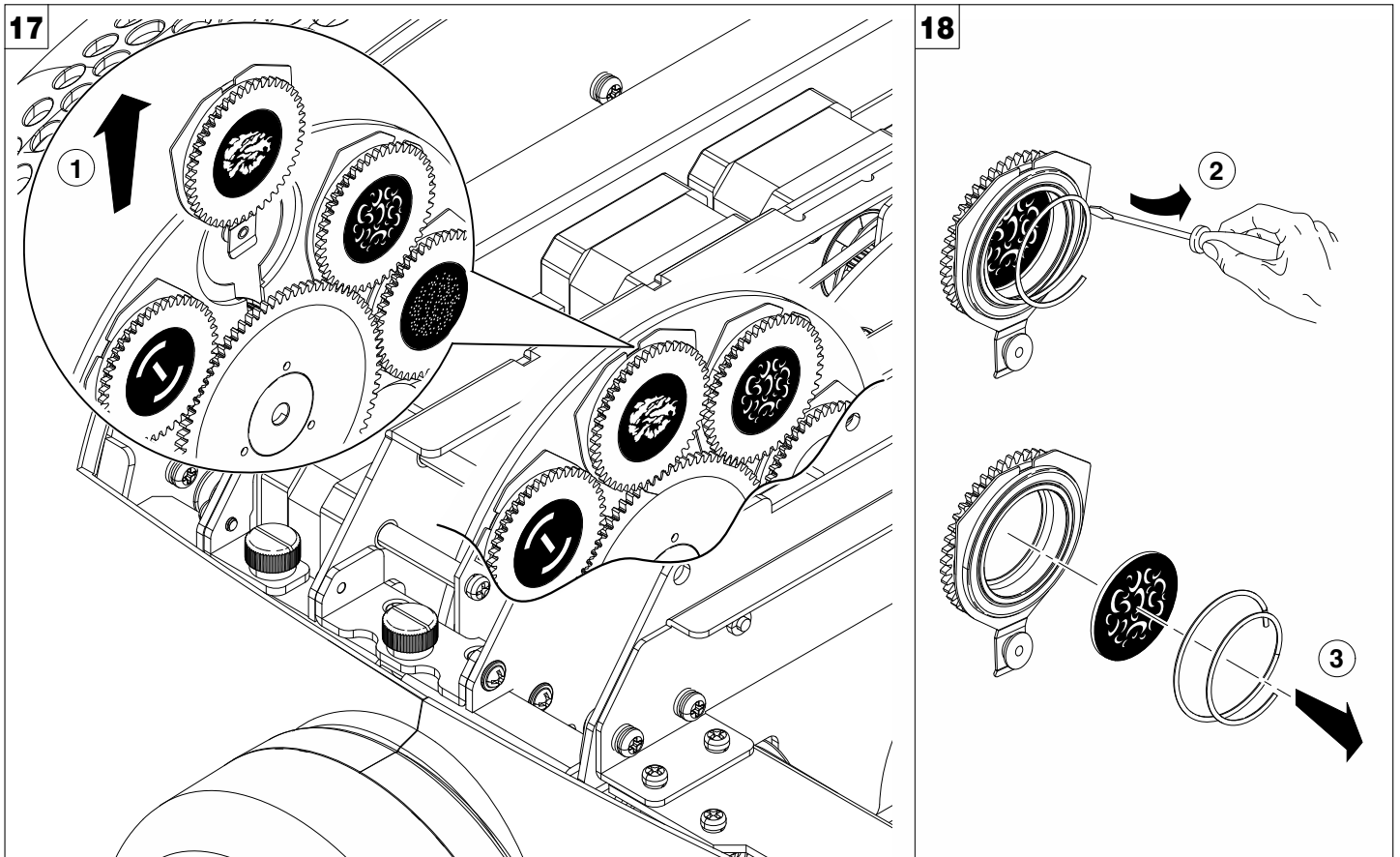

Bearing group replacement - Fig. 17-18

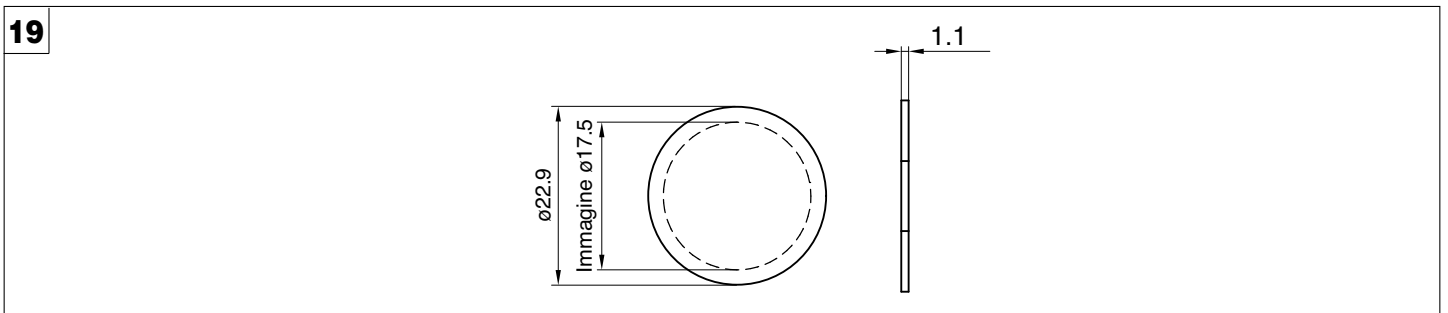

Replacing rotating gobos - Fig. 19

- The original gobos have a special coating designed specifically to resist to the high temperatures;
- The rotating gobo wheel only use dichroic glass gobos (it is not possible to use metal gobos);
- For more information contact Claypaky;

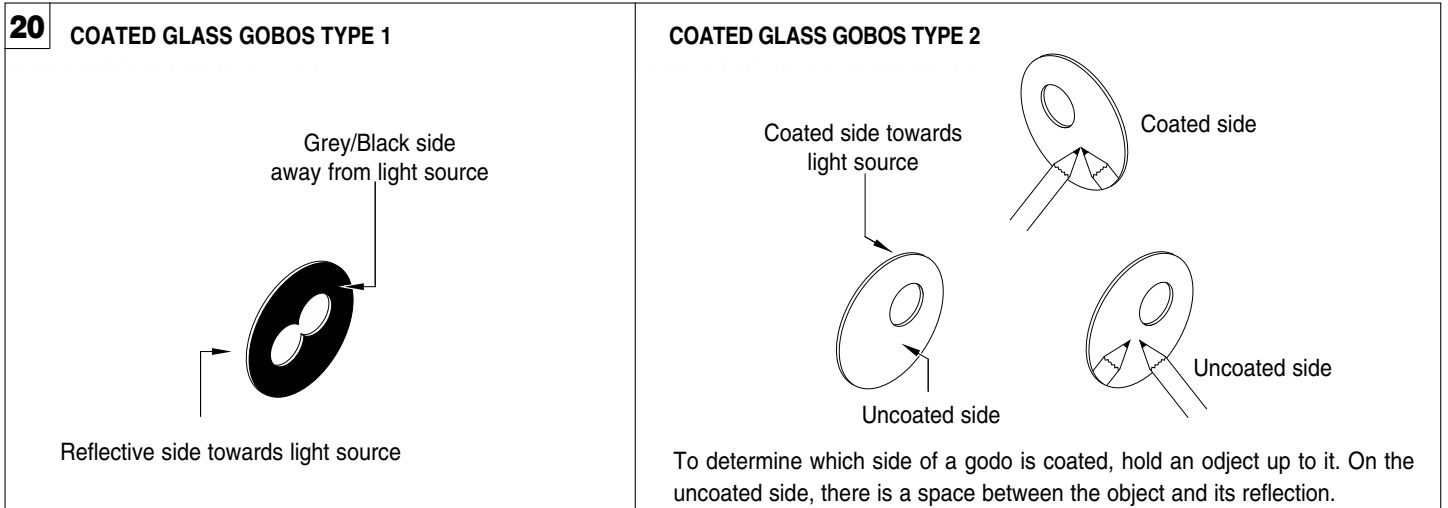

Gobo orientation - Fig. 20

The pictures shown the correct gobos orientation.

## 4.6 Battery removal

21

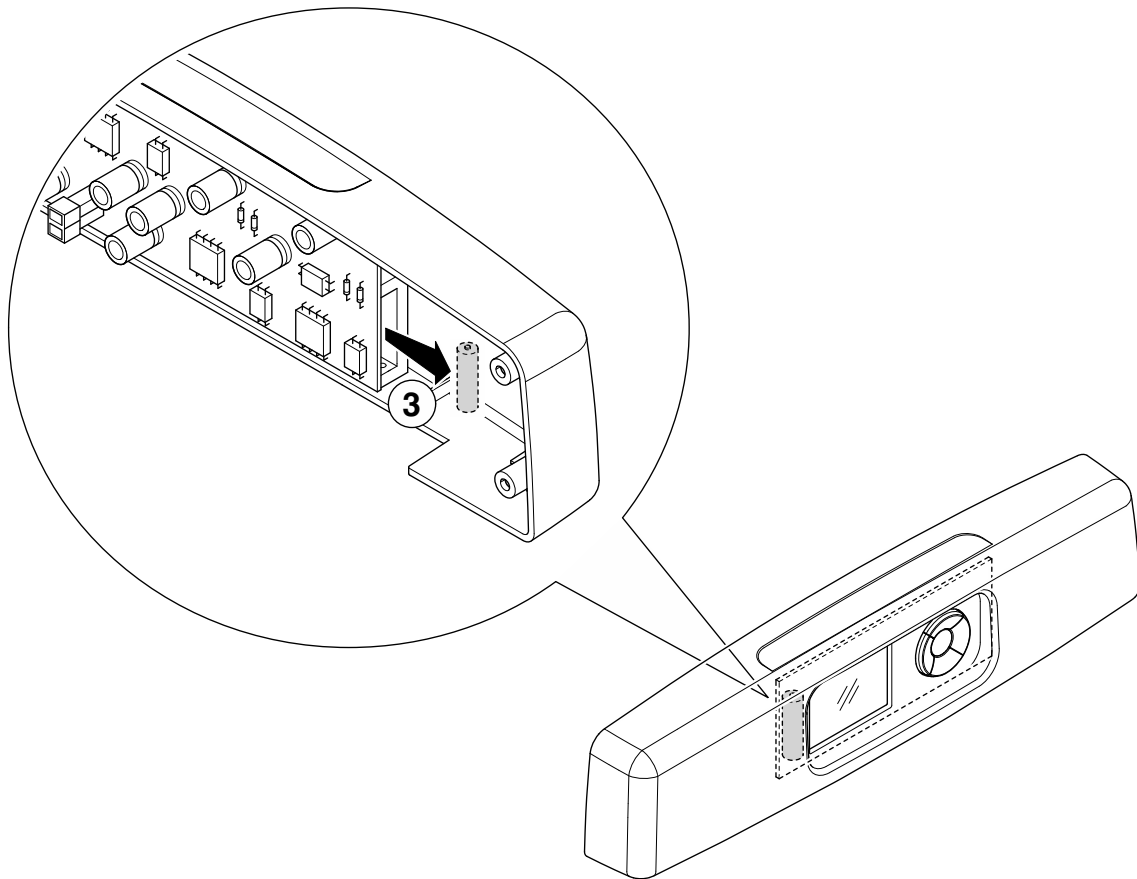
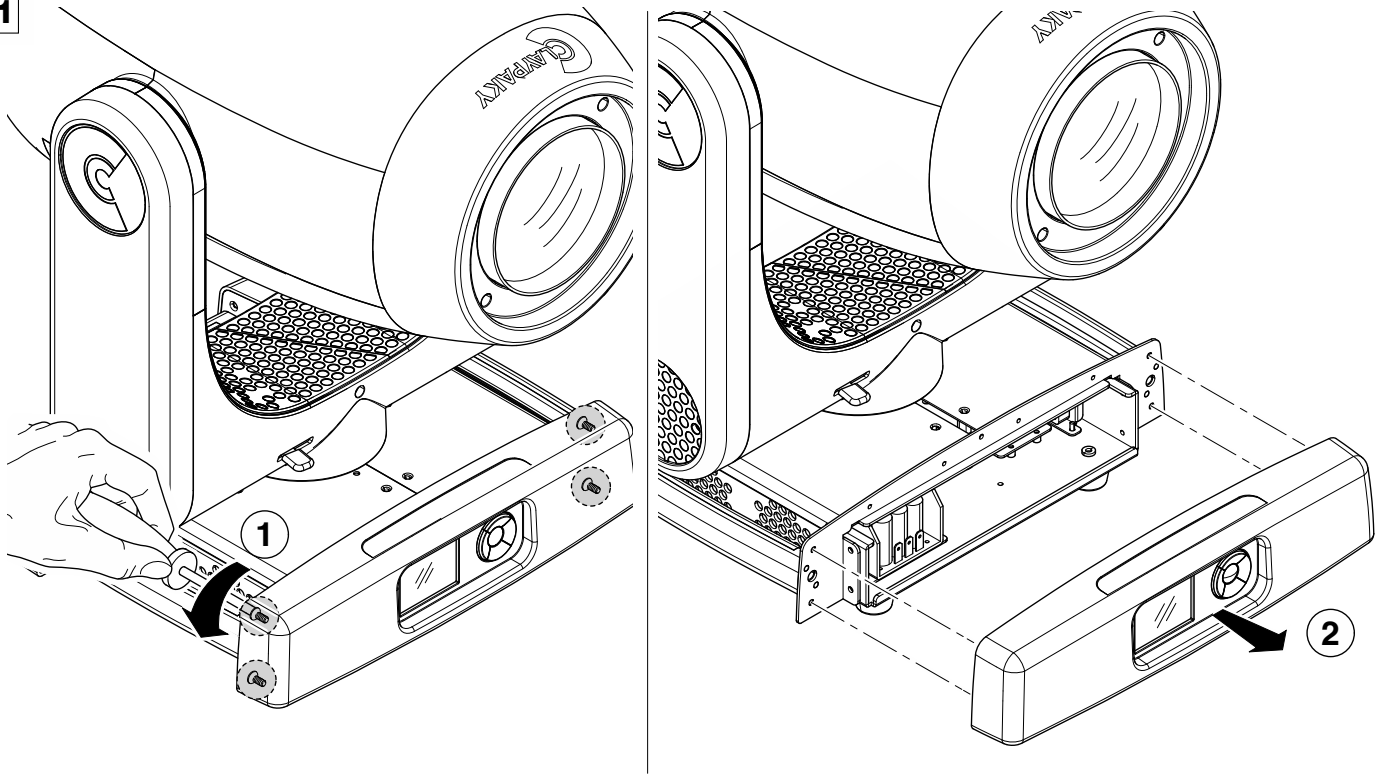

### Battery removal - Fig. 21

This product contains a rechargeable battery. To preserve the environment, please dispose the battery at the end of its life according to the regulation in force.

## 5. SPECIFICATIONS

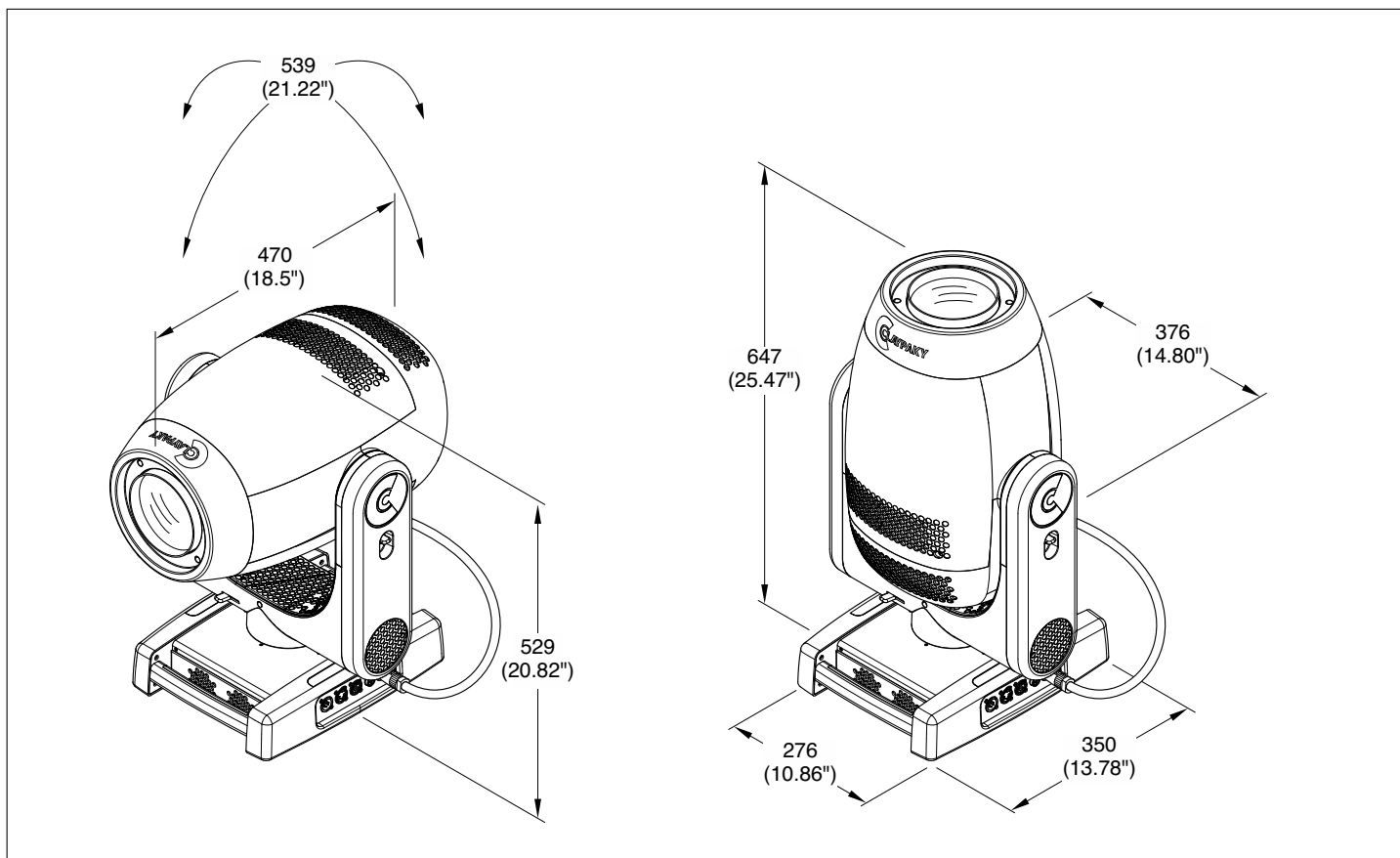

### POWER SUPPLIES

AC power input Neutrik PowerCON True 100-240V, 50/60 Hz

### INPUT POWER

540 VA @230Vac - 50Hz

### LIGHT SOURCE

Source: 300W White LED Module

Versions available:

- CRI: at least 70, CT 6500K (Axcor Spot 400)
- CRI: at least 90, CT 5600K (Axcor Spot 400 HC)

### OPTICS

Ø 125mm front lens  
5°- 55.5° linear zoom

### COLOR SYSTEM

Color system CMY with gradually insertion  
Linear CTO  
Color wheel 6 colors

### EFFECTS SECTION

2 Rotating Gobo wheels : 7 interchangeable gobos  
Animation wheel  
Rotating Prism: 1 x 4-facet prism, indexable on 540°; clockwise and counter-clockwise rotation at variable speed  
Variable frost 0-100% linear  
Iris with multiple macros (random, pulsing...)  
Dimmer 16 bit electronic and linear; 4 dimmer curves  
Strobe 25 flash/sec, electronic, instant open and blackout

### CONTROL AND PROGRAMMING

28 DMX 512 control channels  
Control signal USITT DMX 512  
Protocols RDM, WebServer and Art-Net  
Display Graphic LCD backlit b/w Display  
Display battery Long life self-charging buffer battery  
Pan/Tilt Resolution 16 bit  
Gobo Resolution 16 bit  
Dimmer Resolution 16 bit  
DMX signal connection 5 poles XLR input and output  
Ethernet Input  
Firmware update Software upload through DMX/Ethernet input

### BODY

Aluminum and steel structure with plastic covers  
Two side handles for transportation Device locking  
PAN and TILT mechanisms for transportation and maintenance

### MOVING BODY

PAN range 540°  
TILT range 270°

### ELECTRONICS

Long life self-charging buffer battery  
Function reset from the lighting desk  
"AUTOTEST" function from menu  
Electronic monitoring with status error  
Cooling system monitoring  
DMX level monitoring on all channels  
Internal data transmission diagnostics  
Firmware Upgrade via Web Server  
Firmware upload from another fixture  
Protocols/Functions: RDM, Web Server

### SAFETY DEVICES

Minimum distance of illuminated objects 3 meters (9' 10")  
Minimum distance from flammable materials 0.2 meters (8")  
Max ambient temperature 40°C (104°F)  
Max temperature of the external surface 90°C (194°F)  
6.3AT fuse  
Automatic break in power supply in case of overheating  
Forced ventilation with axial fans

### WORKING POSITION

Working in any position  
Hanging system: with fast-lock omega clamps (1/4 turn) on the base

### CE MARKING

In conformity with the European Directives:

- 2014/35/EU - Safety of electrical equipment supplied at low voltage (LVD)
- 2014/30/EU - Electromagnetic Compatibility (EMC)
- 2011/65/EU - Restriction of the use of certain hazardous substances (RoHS)
- 2009/125/EC - EcoDesign requirements for Energy-related Products (ErP)

### WEIGHT

26 Kg (57.32 lbs)

## CAUSE AND SOLUTION OF PROBLEMS

THE PROJECTOR WILL NOT SWITCH ON			<i><b>PROBLEMS</b></i>
ELECTRONICS NON-OPERATIONAL			
DEFECTIVE PROJECTION			
REDUCED LUMINOSITY			
		<i><b>POSSIBLE CAUSES</b></i>	<i><b>CHECKS AND REMEDIES</b></i>
●		No mains supply.	Check the power supply voltage.
●	●	LED engine defective.	Replace LED engine.
●		Signal transmission cable faulty or disconnected.	Replace the cables.
●		Incorrect addressing.	Check addresses (see instructions).
●		Fault in the electronic circuits.	Call an authorised technician.
	●	Lenses broken	Call an authorised technician.
	● ●	Dust or grease deposited.	Clean (see instructions).